

Warranty

Guarantee and service policy

This product is covered by a standard parts or replacement warranty for a period of 12 months from the date of purchase.

Extend your warranty for 12 months for free by visiting

www.devola.co.uk/warranty

Incorrect installation and failure to follow correct operating instructions are excluded. Consequential costs such as labour charges or damage to surroundings are expressly excluded.

Contact Us

If you experience a problem with this product you should first contact us on 0121 250 2180 before taking any further action.

CLAIM YOUR EXCLUSIVE 5% OFF YOUR NEXT ONLINE ORDER

DISCOUNT CODE: DEV5

OFFER VALID FOR 21 DAYS. DON'T MISS OUT!

YOUR DISCOUNT CODE ALSO APPLIES TO OUR SISTER WEBSITES

Visit our websites:

www.devola.co.uk

www.energybulbs.co.uk

www.airconcentre.co.uk

www.ledbulbs.co.uk

User Manual

AIR CIRCULATOR FAN : DV12PDCFAN

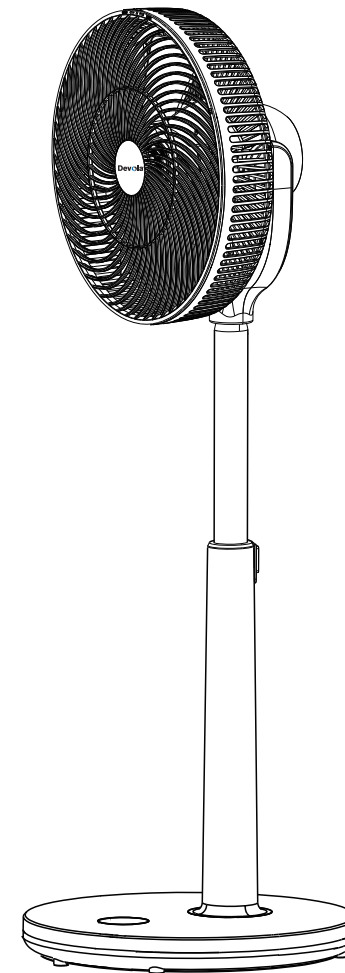

Contents

- Product Instructions
- Oscillation
- Installation
- Technical Parameters
- Safety and Warnings
- Cleaning and Storage
- Fault Analysis and Solution
- Warranty

Product Instructions

01. Parts Identification

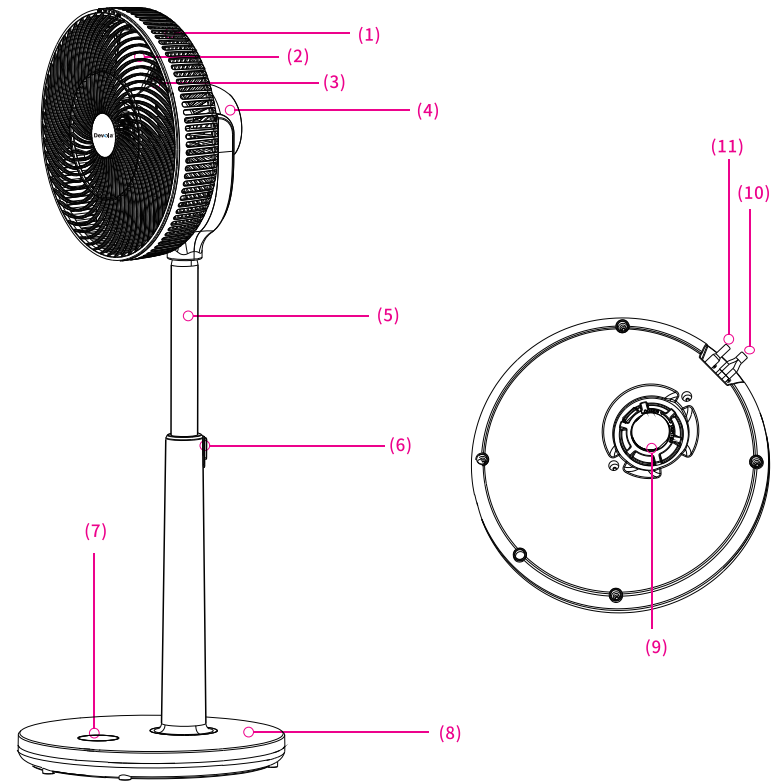

- | | | |
|--------------------|-------------------|-------------------------|
| 1. Rear Guard | 2. Front Guard | 3. Blade |
| 4. Back Cover | 5. Extension Tube | 6. Extended Tube Switch |
| 7. Control Display | 8. Pedestal | 9. Base Fixed Knob |
| 10. AC Connector | 11. DC Connector | |

02. Introduction of Operation Panel

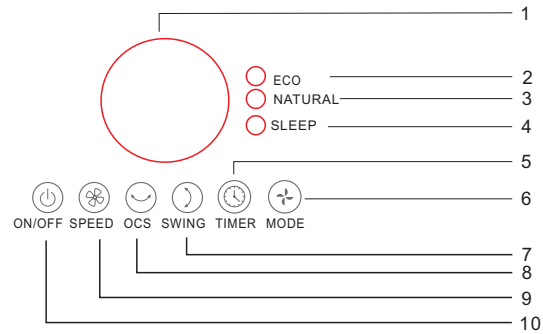

1. Screen	2. ECO Mode	3. Natural Mode	4. Sleep Mode
5. Timer	6. Mode Conversion Key	7. Up-Down Swing	8. Left-Right Oscillation
9. Wind Speed	10. ON/OFF		

03. Function Introduction

- ON/OFF:** When the fan is connected to power, press the ON/OFF button and it will switch on. Press the button again to switch the appliance off.
- TIMER:** There is a 9 hour timer which can be set by the hour to select a time for the fan to switch off. Press the timer button repeatedly until you reach the required hour or until its back to the default of 0, which indicates that no timer is set.
- SPEED:** There are 12 wind velocity speeds. Press the speed button repeatedly to increase the fan speed. When the cycle has reached 12, pressing the speed button a further time will decrease the fan speed back to 1.
- OSC:** Press the OSC button for the fan to vertically swing. Press the button again for the fan to remain fixed in its current position.
- SWING:** Press the swing button for the fan to horizontally swing. Press the button again for the fan to remain in a fixed in its current position.
- MODE:** The fan has three wind modes: Eco, Natural and Sleep. When the fan is in Eco mode, the screen will display the room temperature and the fan speed will automatically adjust based on analysis of the ambient temperature. Natural mode varies the fan speed to simulate a natural sea breeze. In sleep mode the fan speed will remain constant to provide a consistent soothing wind pattern. The wind speed in sleep mode is adjusted to the default wind speed selected by the Eco mode technology in response to the current ambient temperature.

04. Operation of Remote Controller

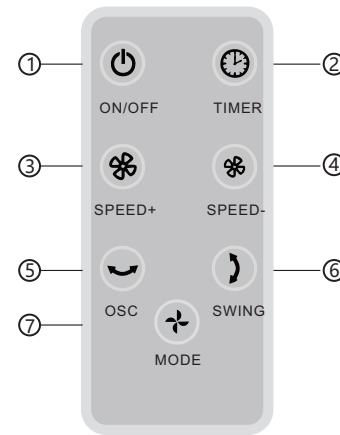

- (1) ON/OFF
- (2) TIMER
- (3) SPEED+
- (4) SPEED-
- (5) OSC
- (6) SWING
- (7) MODE

Note:

- 1. The remote controller is normally used within 6 meters in the front of the product and the deviation angle is within 45 degrees.
- 2. The positive and negative poles of the battery should be connected correctly.
- 3. Once the battery's power has ran out, please sort and recycle the battery safely.

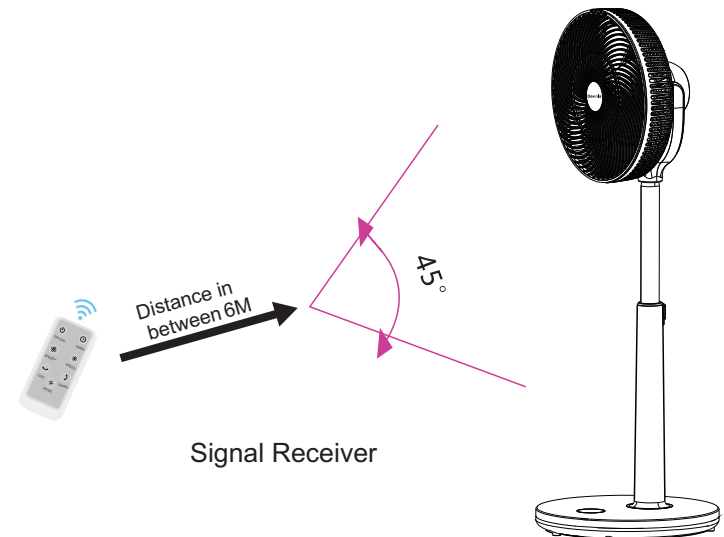

Oscillation

Press the OSC button for the fan to automatically vertically oscillate.

Press the Swing button for the fan to automatically horizontally oscillate.

Left-right oscillation of 100°

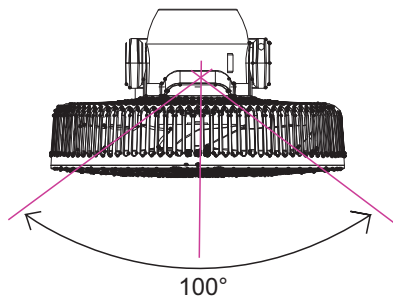

Up-down swing oscillation of 90°

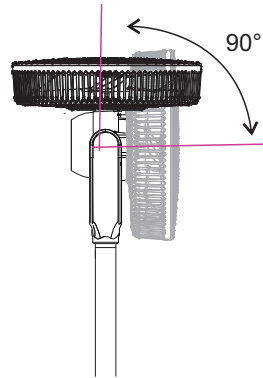

⚡ Note: Do not attempt manual oscillation over 100°.

Installation

1. Take out the Fan's Assembly

Rotate the fan guard clockwise, remove the front mesh and take out the blades.

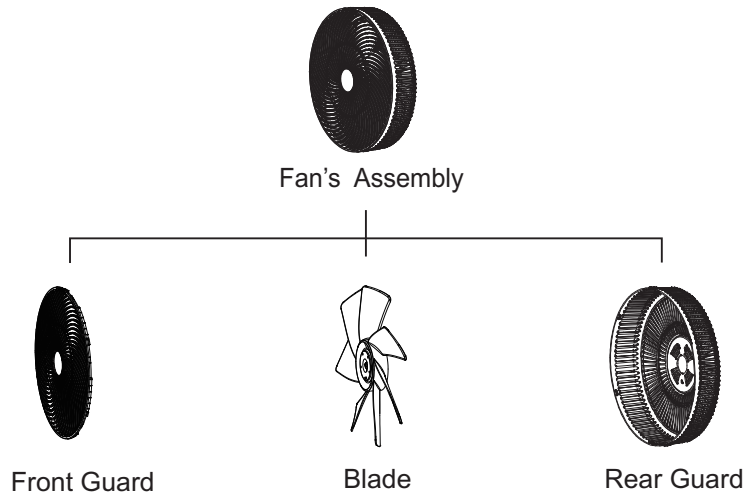

2. Install the Pedestal

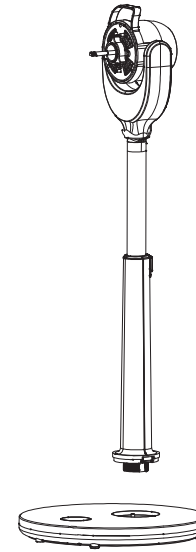

Align motor + support with base socket according to graphic direction, insert lower end of support into base socket

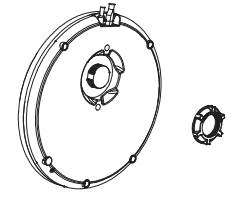

Put the screw into the bottom



Turn the screw clockwise and tighten the base bolt to fix it

3. Install the Rear Guard

Position the rear guard on the motor head and tighten the knob clockwise to attach the guard to the motor head.

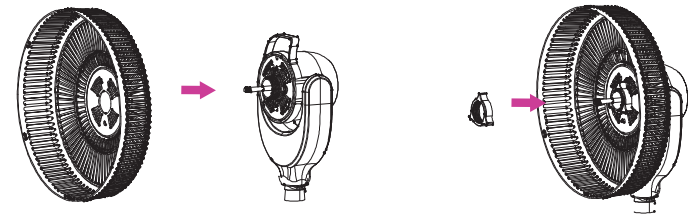

Note: Ensure that the fan blade is tightend, otherwise there is a danger hazard!

4. Install the Fan Blade

Put fan blade to the motor shaft, and tighten the knob clockwise. Then use the screw to fix the front guard.



⚡ Note: Make sure that the fan blade is tightened, otherwise there is a danger hazard!

Fixed Fan Trellis

Insert the fan screw into the hole at the bottom of the fan housing and tighten it clockwise with a cross screwdriver.

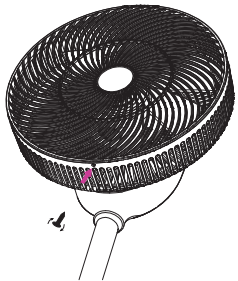

Connect Power

Connect the power cord to the power interface at the bottom of the base and then connect to power. When the fan is connected to power and switched on it will make a 'sound' alert to indicate power connection has been established successfully.

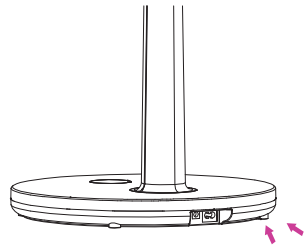

Technical Parameters

01. Basic Parameter

Name:	Air Circulator Fan	Item No.:	DV12PDCFAN
Voltage:	100-240V~	Frequency:	50/60Hz
Power Consumption:	30W	Produce Size:	360*360*1030mm
N.W:	3.0Kg	Noise:	≤54dB(A)

02. Name and content of hazardous substances in products

Name of Parts	Hazardous Substance					
	(Pb)	(Hg)	(Cd)	(Cr(VI))	(PBB)	(PBDE)
Shell	○	○	○	○	○	○
PCB	○	○	○	○	○	○
Package	○	○	○	○	○	○
Inside Wire	x	○	○	○	○	○

This form is edited in accordance with SJ/T 11364

O: indicates that the content of the hazardous substances in all homogeneous materials of the component is below the limit requirements specified in GB/T 26572.

X: indicates that the content of the hazardous substance in at least one of the homogeneous materials of the component exceeds the requirements specified in GB/T 26572.



Safety and Warnings

※01. Warnings

- ⊘ 1. Do not connect or disconnect with wet hands as it will cause short circuit or electronic shock.
- ⊘ 2. Please keep the fan in a steady state when in use.
- ⊘ 3. Do not place this product on high and uneven countertops or floors, avoid any falling damage.
- ⊘ 4. Do not use the power supply beyond the product load, as this may cause overheating and cause the circuit board to burn out.
- ⊘ 5. Do not disassemble or modify this product by yourself.
- ⊘ 6. Do not hit or throw the product as there is a danger of causing internal damage to the body.
- ⊘ 7. Do not put your fingers or other objects into the fan net frame.
- ⊘ 8. This product is not suitable for children to use unattended.
- ⊘ 9. Do not attempt to physically vertically/horizontally oscillate the fan. Ensure you use the control methods enclosed in this manual for automatic oscillation.

※02. Safety Caution

- ⚠ 1. Please read the user manual carefully before using.
- ⚠ 2. Do not allow children to operate the fan without supervision.
- ⚠ 3. Do not place the fan near fire areas or high temperature areas.
- ⚠ 4. Do not place the fan in direct radiation of strong light or hot air.
- ⚠ 5. Do not use wet hands to operate the fan.
- ⚠ 6. Do not use the fan near flammable gases or explosive materials.
- ⚠ 7. Do not place the power wire under carpet to avoid fire caused by power line breakages.
- ⚠ 8. Do not cover the fan head when in use.
- ⚠ 9. Do not place the fan near wet areas such as bathrooms or swimming pools.
- ⚠ 10. If the appliance is not in use for a long period of time, please cut off the power removing the plug from the socket.
- ⚠ 11. Any repairs or maintenance on the fan should be carried out by professional maintenance personnel.
- ⚠ 12. This product has not been designed for purposes other than the function specified in this manual.

Cleaning and Maintenance

- ⚡ **Warning** : Before cleaning, please turn off the power switch and remove the plug from the socket. Do not spray water or spray mist directly on to the fan.
- ⚡ **Cleanable Parts**: Use a screwdriver to remove the screws between the front grill and the rear grill. Use a soft cloth or sponge with a neutral detergent to wipe the exterior. Ensure the parts are dry before reassembling. See below image for guidance:

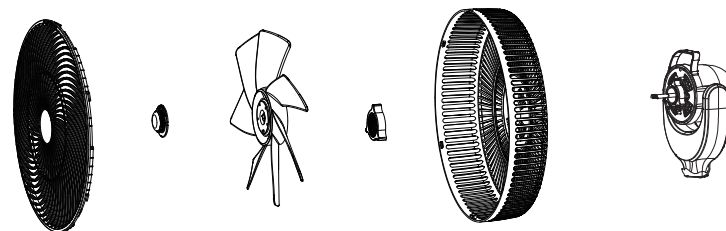

- ⚡ **Cleaning of external non detachable parts**
Use a soft damp cloth to clean the surface. Only use warm water to clean.
- ⚡ **Storage**
If product is not used for a long time, clean it and dry it, then put it into the original packing box and store in a dry place.

Fault Analysis and Solution

Fault	Reason	Methods
Indicator light or LED screen not working or no wind circulating.	The power plug is not plugged in properly.	Check the power plug and/or socket.
To the remote control is not working.	The battery is out of/low in power. The battery is not properly installed. The remote control does not point to the receiver position or is out of the control distance range.	Change the battery. Check the battery has been installed properly. Point the controller to the receiver position. Ensure you are within the control distance range of 6M.
Abnormal noise when in use.	The fan head has not been assembled properly. The fan blades are not fixed in position correctly. The fan cover and blades are touching.	Ensure the fan head is installed correctly, use this manual for reference. Ensure the cover and fan blades are installed correctly and are not touching.
Wind speed reduction.	There is a build up of dust on the blades and net.	Remove the dust with a damp wet cloth.

**If the problem can not be eliminated, please contact our local after-sales service department.
Do not disassemble and repair by yourself.**