



EH1804

**18" (45cm) Pedestal Fan
Ventilateur 40cm**

3 Vitesses,Inclinable

3 speed, Adjustable

User Manual

Notice d'Utilisation

IMPORTANT

Installer and Users please note:

These instructions should be read carefully and left with the user of the product for future reference.

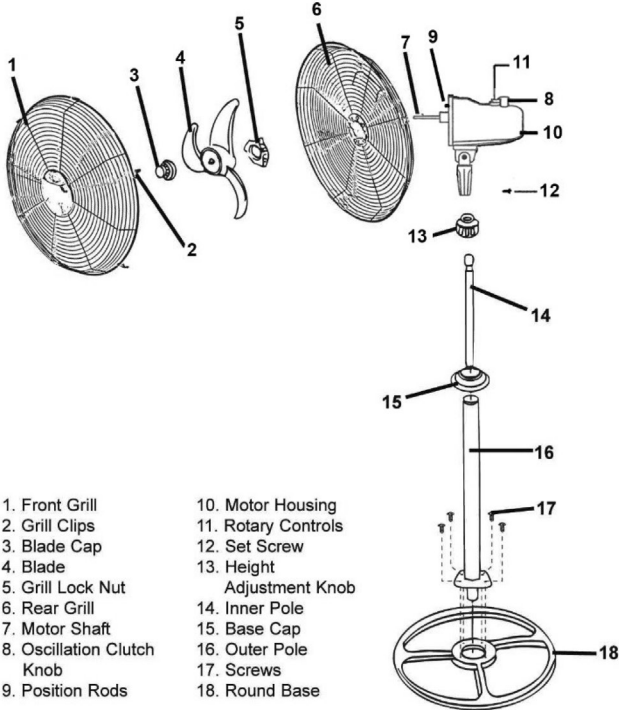

Assembly

To assemble the fan;

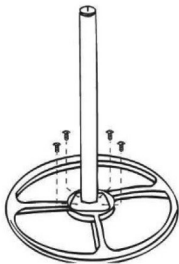

1. Secure the outer pole (16) to the Base (18) using the 4 screws (17)

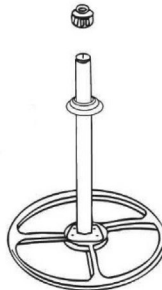

2. Feed the base cap (15) over the outer pole and slide down to the base.

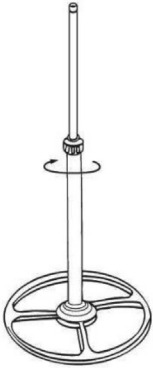

3. Extend the inner pole (14) to the desired height and turn the height adjustment knob (13) clockwise to secure in place.

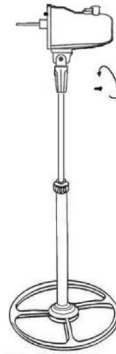

4. Place the motor housing (10) on the inner pole and turn the set screw clockwise (12) to secure the motor housing in place.

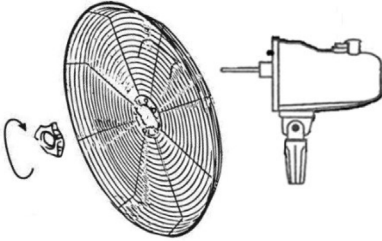

5. Place the rear grille (6) over the motor shaft (7) and secure with the grille lock nut (5) by turning clockwise till tight.

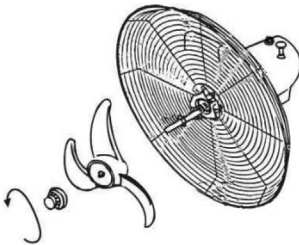

6. Slot the fan blades (4) on to the motor shaft (7) by aligning the D shaped hole on the blades with the shaft. Secure by attaching the blade cap nut (3) and turning anti-clockwise.

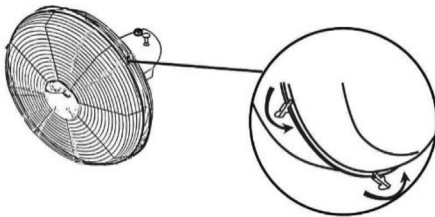

7. Hook the front grille (1) to the rear grille (6) with the hook at the top of the front grille. Close the grille clips (2) around the edges of the front grille to secure the two halves together.

BEFORE USE

You must inspect the product including its cable and plug for any signs of damage. If the product is damaged, DO NOT use it, and contact your supplier immediately.

PRODUCT SAFETY

- This appliance can be used by children aged from 8 years and above and persons with reduced physical, sensory or mental capabilities or lack of experience and knowledge if they have been given supervision or instruction concerning use of the appliance in a safe way and understand the hazards involved.
- Children shall not play with the appliance.
- Cleaning and user maintenance shall not be made by children without supervision.
- Do not use in close proximity to gas appliances
- Do not use unless correctly installed.
Do not cover when in use.
- Do not place the mains lead beneath a carpet or rug.
- Do not use the appliance in locations where paint, petrol or other flammable liquids are used or stored.
- Not suitable for use in boats, caravans or other similar areas.
- Do not insert any object into the appliance through the grilles. This may damage the appliance or result in overheating or electric shock.
- Do not use this appliance in the immediate surroundings of a bath, a shower or a swimming pool.
- The appliance is fitted with an overload cut-out which will operate if the motor overheats or is stalled. If this happens, disconnect from the mains supply immediately, and allow the motor to cool down.

OPERATION

- Plug the mains lead into a 13 Amp mains socket. If any other appliances are connected to the same extension lead, make sure that it is rated for the total power of all appliances connected.
- If connecting via an extension lead, make sure that the lead is rated at 3 Amps or more, and that it is fully unwound.
- Switch the appliance on at the mains socket.
- Use the control knob (11) to start the fan. The fan has 3 speeds and OFF.
 1. Slow
 2. Medium
 3. Fast
- The Oscillation Clutch Control (8) button allows the unit to oscillate the fan head to cover a greater area. Lift to disengage, push down to engage.
- To switch turn the control to 0

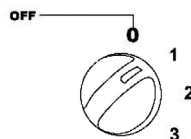

- It is normal for the motor to become warm during use.
- Unplug the appliance from the mains when not in use.

OPERATING COSTS

At time of going to press, the average cost of electricity is £0.13 per unit (kilowatt-hour). The amount you are being charged will be shown on your electricity bill. At this cost, the EH1702 will cost 17.7p per day to run on the "low speed" setting, or 23p per day to run on the "high speed" setting.

PAT TESTING

When used in an office environment, we recommend that this product should be safety-tested yearly by a qualified electrician (PAT Tested).

We recommend that it is PAT tested regularly when used in a domestic environment.

GENERAL SAFETY REQUIREMENTS

Domestic wiring must be tested periodically by a qualified electrician at least once every 10 years or at every change of occupancy.

For office and retail premises, and buildings such as village halls, the wiring must be inspected at least once every 5 years.

It is recommended that all building be fitted with smoke alarms (it is mandatory for new buildings).

DISPOSAL AND RECYCLING

You must not dispose of this appliance with domestic household waste.

Most local authorities have specific collection system for appliances and disposal is free of charge to the end-user.

When replacing an existing appliance with a similar new appliance your retailer may take the old appliance for disposal.

MAINTENANCE

Before cleaning, turn the appliance off, and disconnect from the mains supply. The appliance may then be cleaned using a damp cloth with a drop of washing-up liquid to remove any dust or dirt from the case. Do not use stronger detergents or solvents as these may damage the paint finish.

Using a dry 1" (25mm) paint-brush, remove any dust from the grilles.

If the mains lead is damaged, it must be replaced by the manufacturer or an authorised service centre.

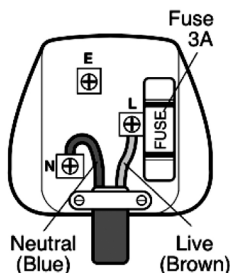

If the mains plug needs to be replaced, proceed as follows:

- Connect the brown wire to the terminal labelled "L".
- Connect the blue wire to the terminal labelled "N".
- Make sure that the cord-grip is positioned correctly (over the outer sheath of the cable) and it fully tightened.
- If the plug is fitted with a 13 A or 5 A fuse, replace it by a 3 A fuse.

TECHNICAL SPECIFICATION

Dimensions: 1300×505×505 mm

Weight: 4.41 kg

Power supply: 230 V ~

Power consumption

Low Speed 57W

Med Speed 63W

High Speed 75 W

Air flow Low Speed 3684m³/h

Med Speed 4212m³/h

High Speed 5058 m³/h

Operating current:

Low Speed 0.26A

Med Speed 0.28A

High Speed 0.31 A

Air speed: Low Speed 2.65m/s

Med Speed 3.27m/s

High Speed 4.08m/s

Sound Power Level (max.): 65 dB(A)

Service value: 1.12 m³/W/min

SERVICE WARRANTY

Prem-i-Air guarantees the product free from defects in materials and workmanship for a period of twelve months.

Should this appliance be operated under conditions other than those recommended, at voltages other than the voltage indicated on the appliance, or any attempts made to service or modify the appliance, then the warranty will be rendered void.

The product you buy may sometimes differ slightly from illustrations. This warranty is in addition to, and does not affect, your statutory rights.

Our guarantee is administered by our retailers.

If your product arrives damaged, you must contact the retailer from whom you bought it. The retailer's contact details will be on the invoice that arrived with the product, or on the e-mail you received when you placed the order. Do not contact Prem-i-air, only your retailer can arrange a replacement.

If your product fails within the guarantee period, firstly read the "fault finding" section of this manual, because temperature and weather conditions can affect the performance of certain products. If the product needs to be repaired or replaced, you must contact the retailer from whom you bought it.

The retailer's contact details will be on the invoice that arrived with the product, or on the e-mail you received when you placed the order.

If you have just received your product and require technical help in using it, please call our Help Desk on (0845) 459 4816

If you have any other technical queries about the product, please call our Help Desk on (0845) 459 4816.

Prem-i-Air Appliances Ltd.,
Lancots Lane, Sutton,
St. Helens, Merseyside.
WA9 3EX
website: www.prem-i-air.com

