

DIMENSIONS

| References | Watt | A mm | B mm | C mm |
|------------|------|------|------|------|
| DAR050 | 500 | 410 | 160 | 147 |
| DAR075 | 750 | 490 | 240 | 147 |
| DAR100 | 1000 | 490 | 240 | 147 |
| DAR150 | 1500 | 730 | 481 | 147 |
| DAR200 | 2000 | 970 | 481 | 227 |

Fig. 1

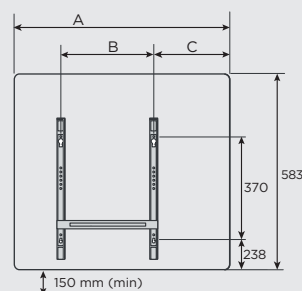

THESE INSTRUCTIONS SHOULD BE READ CAREFULLY AND RETAINED FOR FUTURE REFERENCE

WARNING – Some parts of this unit can become very hot and can cause burns.
Be especially careful in the presence of children and vulnerable people.



Caution, hot surface

- This unit may be used by children who are at least eight years old and by people with reduced physical, sensorial or mental capacity or those lacking experience and familiarity, if they are properly supervised or if instructions for the safe use of the unit were given to them and the risks involved were understood. Children must not play with the unit. Unsupervised children must not clean or perform upkeep on the unit.
- Keep children under the age of 3 away from the unit unless they are constantly supervised.
- Children between the ages of 3 and 8 can only turn the unit on or off, as long as the unit was placed or installed in a normal position as intended and these children are supervised or have received instructions regarding the safe use of the unit and properly understand the potential dangers.
- Children between the ages of 3 and 8 must not plug in, adjust or clean the unit, nor carry out user upkeep.
- If the unit is covered, there is a risk of overheating. The facing logo provides a reminder of this risk.



Warning : do not cover



- It is therefore strictly forbidden to cover or to block the air intake and outflow points as this could lead to failures or deterioration of the unit.
- Do not insert anything into the unit.
- The electrical connection of this unit must be done when it is turned off and by a qualified person.
- All work on units must be done with the units turned off and by qualified persons.
- The electrical power supply of the unit must be switched with a double pole switched fused connection unit with suitably rated fuse.
- The unit must not be installed under a power socket.
- The electrical power supply must be protected by a rated residual current device at most equal to 30 mA, particularly in the case of installation in a room with a bathtub or a shower.

- If the power cable is damaged, it must be replaced by the manufacturer, its after-sale service department or a similar qualified person in order to avoid all danger.

- Respect the minimum distances for installation on the floor, walls, furniture, etc. (Fig. 2).

- Avoid installing the unit in an air draft which can affect the proper room temperature control.

- The unit must be fastened to its support. The use of adhesives to fasten the support or the unit is forbidden.

WARNING: Do not use this heating unit in small rooms when there are people in them who cannot leave the premises on their own, unless there is constant surveillance.

"The electrical installation of this heater must be carried out by a suitably qualified or trained electrician, and be in strict accordance with current wiring regulations BS 7671"

Installation of units

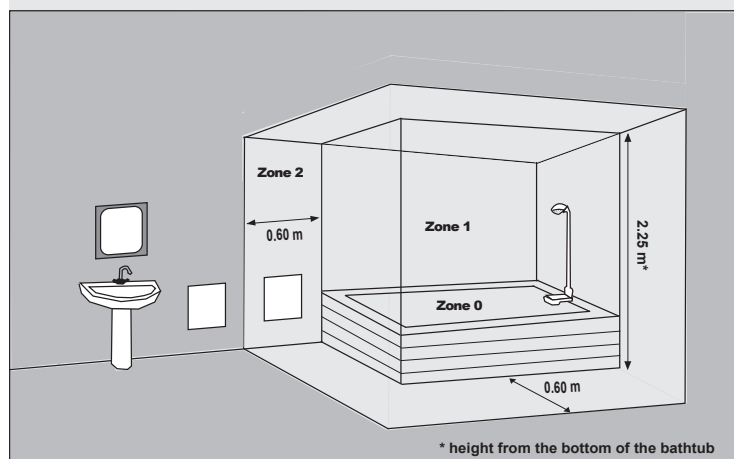

- This heating unit is filled with a precise quantity of special oil. Repairs that require opening the oil tank must only be done by the manufacturer or its after-sale service department, which should be contacted in the event of an oil leak;
- When the heating unit is discarded, follow the rules for the elimination of oil.

(*) This notice was drafted at the time of the manufacturing of the unit and in compliance with the standards in effect as of this date.

The manufacturer reserves the right to modify the installation and use notice at any time to take the standards and their changes into account.

Energy Related Product Directive

This product complies with Lot20 of the Energy Efficiency Directive (2015/1188)

| Model Identifier(s): | | DAR050 | DAR075 | DAR100 | DAR150 | DAR200 |
|---|---------------------|--------|--------|--------|--------|--------|
| Nominal heat output | P _{nom} | 500 W | 750 W | 1000 W | 1500 W | 2000 W |
| Minimum heat output (indicative) | P _{min} | N.A | N.A | N.A | N.A | N.A |
| Maximum heat output | P _{max,c} | 500 W | 750 W | 1000 W | 1500 W | 2000 W |
| Auxiliary electricity consumption | | | | | | |
| At nominal heat output | e _{lmax,c} | 0 | 0 | 0 | 0 | 0 |
| At minimum heat output | e _{lmin} | 0 | 0 | 0 | 0 | 0 |
| In standby mode | e _{lSB} | <1W | <1W | <1W | <1W | <1W |
| Control options | | | | | | |
| Electronic room temperature control plus week timer | | Yes | Yes | Yes | Yes | Yes |
| With distance control option | | Yes | Yes | Yes | Yes | Yes |
| With adaptive start control | | Yes | Yes | Yes | Yes | Yes |
| With open window detection | | Yes | Yes | Yes | Yes | Yes |

General Information

The heater is designed for wall mounting using the wall bracket supplied. It should only be operated when in the upright position as shown (see Fig. 1). All models are splash proof to IP24. Before connecting the heater check that the supply voltage is the same as that stated on the heater.

Electrical Connection

-The electrical installation of this heater must be carried out by a suitably qualified or trained electrician, and be in strict accordance with current wiring regulations BS 7671

-The unit must be connected to a 230V 50Hz electricity network, switched with a double pole switched fused connection unit with suitably rated fuse.

to match the above :
BROWN = PHASE
BLUE or GREY = NEUTRAL
YELLOW / GREEN = CPC (CIRCUIT PROTECTIVE CONDUCTOR)

-Verify the correct connection of all of the wires in the terminals of the double pole switched fused connection unit.

Wall Mounting

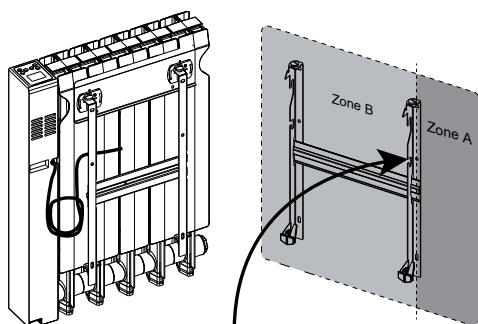

Connect the cable to its feed point. Make sure that any excess cable is fed into Zone A, and that it is held in the hook provided.

Ensure minimum distances are maintained as shown in Fig. 2 below

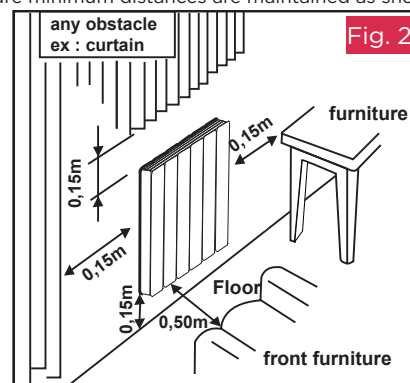

Wall Bracket Installation Steps:

STEP 1

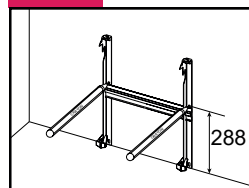

STEP 2

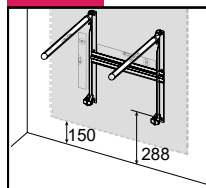

STEP 3

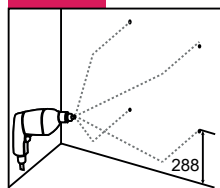

STEP 4

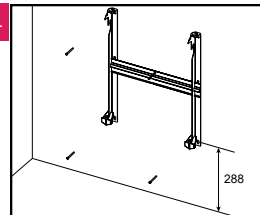

STEP 5

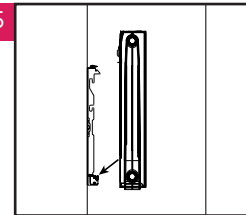

4. Fasten the bracket to the wall with 4 screws of 6mm diameter
5. Hang the appliance to the bottom part of the bracket

Suggested fixings:

SOLID BRICK/BLOCK: No. 10 size high temperature resistant plastic inserts, 8mm drill bit. Drill hole 15mm deeper than plastic insert length.
PLASTERBOARD: If possible locate studding and use No. 10 woodscrews directly into the wood, otherwise M5 rawplug intersets are suitable.

STEP 6

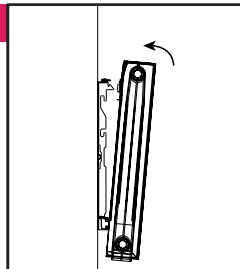

STEP 7

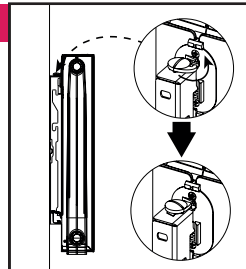

6. Raise the upper part of the appliance toward the upper part of the bracket.
7. Hang the appliance to the bracket and lock it with a screwdriver on the locks in an anti-clockwise direction.

ON/OFF switch

The on/off switch is located on the back of the unit, and should only be used for prolonged shutdowns (not during heating periods). When the switch is in the off position, the unit is no longer supplied with energy and you may need to reset the date and time at next startup.

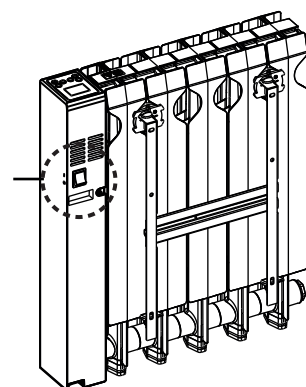

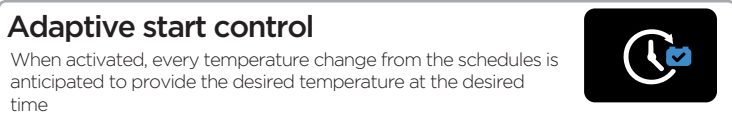
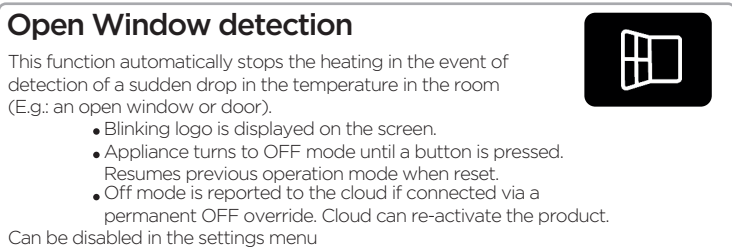
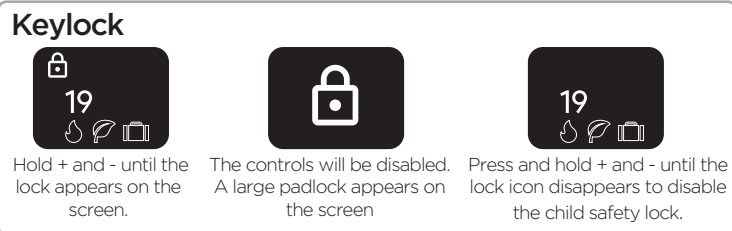
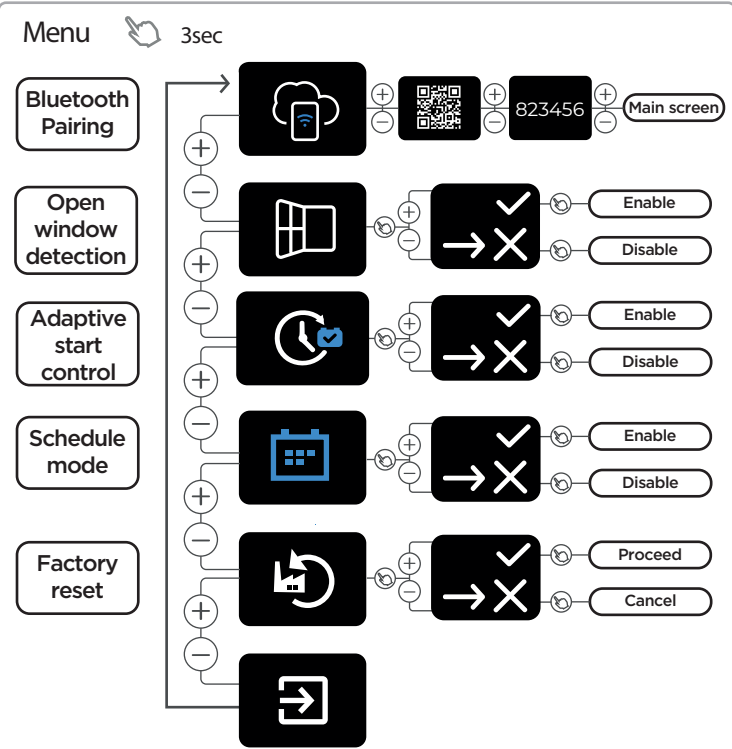
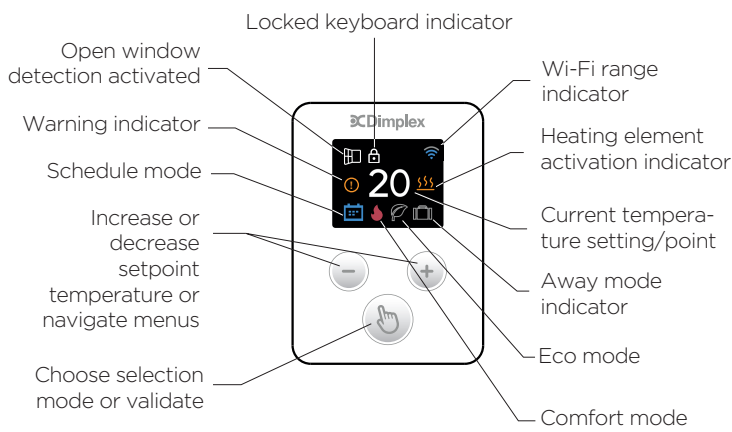

Embedded Scheduling system



Choose this item from the main menu to tune the onboard scheduler. Please note that when the appliance is connected to CAPA Connect, the onboard scheduler will be inactive and this item will disappear from the menu.

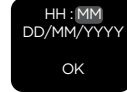

Set the current time and date with +/- buttons and jump to next field with the "hand" button.



Choice of comfort / setback temperatures
Selection via +/-, validation of each field step by step with OK with the "hand" button.

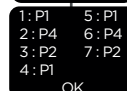

On this screen, you can choose the schedule pattern to associate to each day of the week, 1 being Monday and 7 being Sunday.

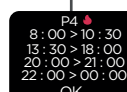
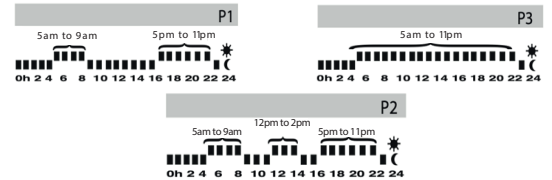

First time that P4 is selected, an additional edition screen pops up to choose up to 4 comfort periods in the day.

Coherence of the user inputs for the schedule is checked by the appliance



If scheduler is active, this screen is used to disable it

While onboard scheduler is active, manual temperature setting overrides from the main screen are dealt as temporary overrides until the next time/ temperature period setting starts

Download Capa Connect Application



Download the Capa Connect app to your smartphone or tablet, and follow the instructions on screen.



Setup Capa Connect & Voice assistant



Use your smartphones camera to scan the QR code and open web instructions. Click on **Adding heater to** for step by step instructions.



Application Setup



To add a heater to your site, press the "+" button in the top, right corner of the Control screen.

Enter the product identification code (GDID) and PIN code. Both codes are found on a label at the side of the heater. The codes can be entered manually, or by scanning the QR code on the label.



The heater needs to be paired with your Wi-Fi network. This is done by activating the Bluetooth (BLE) discovery mode on the heater. To activate Bluetooth search, press '+' and '-' simultaneously for 3 seconds.

Make sure Bluetooth is activated on your smartphone or tablet and follow the instructions in the app. For Android devices, device location services must also be switched on. Select your preferred Wi-Fi network from the list and enter the Wi-Fi password when prompted.

Security and Telecommunications Infrastructure Regulations UK 2023

This product complies with the Product Security and Telecommunications Infrastructure (Security Requirements for Relevant Connectable Products) Regulations UK 2023



Statement of Compliance (SoC), calling up all relevant products and a defined period of support for critical security updates is available here :

To view the full PSTI Regulation SoC for your product scan this QR code



In addition, as per the above regulation Dimplex provides a means for customers and responsible actors to report platform vulnerabilities, the Vulnerability Disclosure Policy is available here:

To view the Vulnerability Disclosure Policy scan this QR code

Maintenance

There are no user replaceable parts on this electric radiator.

The electric radiator is filled with a precise quantity of special liquid and for electric only operation should never need draining or refilling. Any leakage must be reported to the manufacturer's Service Agent.

Any maintenance must be carried out by the manufacturers Service Agent using the recommended parts.

Cleaning

The surface finish on your electric radiator can be maintained by occasionally wiping over with a damp cloth and lightly finishing with a soft dry cloth. This should only be carried out when the radiator is cold and switched off completely. Do not use abrasive cleaning products as this could damage the surface finish.

Your Guarantee



To view the full guarantee terms and conditions scan this QR code using your smartphone or go to <https://www.gdhv.co.uk/guarantee-terms-and-conditions>.

Your Product is manufactured by Glen Dimplex Group. Glen Dimplex Group design and manufacture products to ensure they deliver reliable service for use in normal domestic dwellings and where specified by us, in light commercial premises.

Our products are individually tested before leaving the factory, Your product comes with a 2 year parts and labour guarantee for repair or replacement of faulty goods and/or partial refund in the event that a repair or replacement is not available. The 2 year guarantee is extended for an additional 3 years when you register the product with Dimplex, within 28 days of purchase. If you do not register the product with Dimplex within 28 days, your product will remain guaranteed for 2 years only. To validate your extended guarantee register with us online at: www.dimplex.co.uk

Your guarantee is provided by Glen Dimplex UK Ltd operating as Glen Dimplex Heating & Ventilation Ltd, Millbrook House, Grange Drive, Southampton SO30 2DF. Terms and conditions apply.

The GDHV guarantee does not in any way diminish or affect your statutory consumer rights in connection with your product.



If you experience a problem with your product during or after the guarantee period, visit our online help centre: support.dimplex.co.uk

For ROI please email serviceireland@glendimplex.com or call +353(0)1 842 4833.

Please note for support you will need the model and serial number of your product and a description of the fault which has occurred.



For electrical products sold within the European Community.

At the end of the electrical product's useful life it should not be disposed of with household waste.

Please recycle where facilities exist. Check with your Local Authority or retailer for recycling advice in your country.

Batteries should be disposed of or recycled in accordance with WEEE Directive 2012/19/EU. Packaging should be recycled where possible.



Customer Helpline: 0344 879 3588

www.dimplex.co.uk

Glen Dimplex Heating & Ventilation

Millbrook House, Grange Drive, Hedge End, Southampton, SO30 2DF

© Glen Dimplex UK Limited. All rights reserved. Material contained in this publication may not be reproduced in whole or in part, without prior permission in writing of Glen Dimplex



This product complies with the European Safety Standards EN60335:2-30 and the European Standard Electromagnetic Compatibility (EMC) EN55014:1, EN55014:2, EN61000:3-2 and EN61000:3-3 which cover the essential requirements of EMC Directive 2014/30/EU and the LVD Directive 2014/35/EU.