

devola

Comfortable living everyday

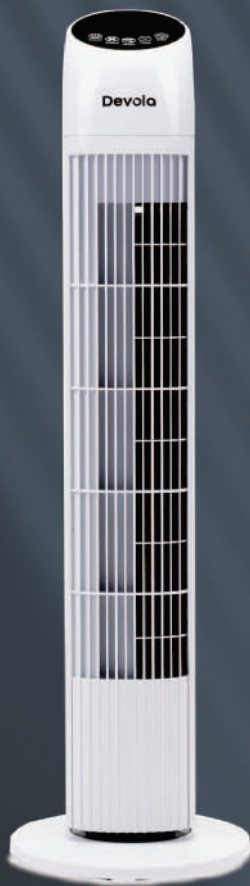

33" Tower Fan

DV33TFB / DV33TFWH / DV33TFBW

Instruction Manual

devola.co.uk

Thank you for choosing Devola

Congratulations on the purchase of your new Devola product. Please read the following instructions carefully and follow them to prevent possible damages. We assume no liability for damage caused by disregard of the instructions and improper use.

Contents

Safety information	1
Product features	3
Operation	4
Cleaning and maintenance	5
Warranty	6



Please read the USER MANUAL carefully before operation

Safety instructions

Please read these important safety instructions carefully before using the appliance. They are intended to help prevent fire, electric shock, injury or property damage.

- **Use this appliance only as described in this manual.** Any other use may result in fire, electrical shock, or injury. This will also invalidate the warranty.
- This appliance may be used by children aged 8 years and older, as well as by individuals with reduced physical, sensory, or mental capabilities, or those lacking experience or knowledge, provided they have been properly supervised or instructed on the safe use of the appliance and understand the associated risks.
- **Children must not play with the appliance.** Cleaning and maintenance must not be carried out by children without appropriate supervision.
- **Children under the age of 3 must be kept away from the appliance at all times** unless under continuous supervision.
- **Children aged between 3 and 8 years may only switch the appliance on or off**, and only if it has been installed in its normal operating position and they have been supervised or instructed on its safe use and fully understand the potential hazards.
- **Children between 3 and 8 years of age must not plug in**, adjust settings, clean, or perform any maintenance on the appliance.
- Always connect the appliance to a **properly earthed 220–240V AC power supply**.
- Avoid using a high-wattage appliance on the same electrical circuit.
- **Do not use the appliance if the power cord or plug is damaged.** Contact the manufacturer.
- **Do not extend the power cord** or use extension leads.
- The socket-outlet must be accessible at all times to enable the mains plug to be disconnected as quickly as possible.
- Avoid placing the power cable in areas where it may become a **tripping hazard**.
- **Do not pull, kink or wrap the power cable** around the appliance as this may weaken the internal wires.
- This appliance is intended for indoor use only. Do not operate the appliance outdoors.
- **Place the appliance on a flat, stable surface** in an upright position. Operating in any other position could cause a hazard.
- **Never cover the appliance.** Covering it may cause it to overheat and catch fire.
- **DO NOT** place the appliance:
 - o Within 50cm of objects, such as curtains, furniture, paper, bedding.
 - o Within 1.5 metres of any flammable objects.
 - o With the safety guard removed.
- **Do not use in areas with flammable gases, vapours or dust** (e.g. garages or workshops).
- Ensure the appliance is **never positioned where it could fall into water**.

- Never operate the appliance with **wet hands** or pull the plug out by the cord.
- The switch or controller **must not be reachable from any bodies of water**.
- **Do not insert fingers or objects** into the appliance when in operation.
- **Do not leave the appliance on unattended** or while sleeping.
- Before cleaning or repositioning:
 - Switch the appliance off.
 - Unplug from the mains.
- Only clean the appliance with a **soft cloth** - no solvents or abrasives.
- You may notice a faint odour when the appliance is used for the first time. This is completely normal and will fade within a few minutes.
- **Do not attempt to open**, repair or modify the appliance yourself. Contact the manufacturer.

Warning

Failure to follow these instructions could lead to **severe consequences**, including explosion, property damage, injury, or even death.

To avoid danger of suffocation please remove all **packaging materials** particularly plastic and EPS and keep these away from vulnerable people, children and babies.

To avoid the risk of **accidental strangulation** from the supply cord all children and vulnerable people must be supervised when in the vicinity of the product whether it is working or not.

Specification	DV33TFWH	DV33TFBW	DV33TFB
Voltage	220-240V	220-240V	220-240V
Frequency	50Hz	50Hz	50Hz
Power	45W	45W	45W
Product Size (mm)	840x240x240	840x240x240	840x240x240
Product Weight	2.6kg	2.6kg	2.6kg
Colour	White	Black & White	Black

Note: The images and illustrations in this user manual are provided for demonstration purposes only. Actual product design, features, and appearance may vary slightly depending on the model or specification.

Features

1. LED Display
2. Control Panel
3. Air Outlet
4. Security Grill
5. Base

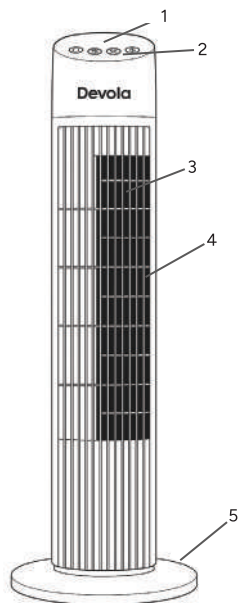

Assembly

1. Remove contents from the box.
2. Connect the first part of the base (D) to the second part of the base (E). Secure the base to the bottom of the fan using the screws provided (F).
3. Please note that the fan cannot be used without the base attached.
4. Place the fan on a flat level floor.
5. Connect the fan to a power outlet and turn the fan on.

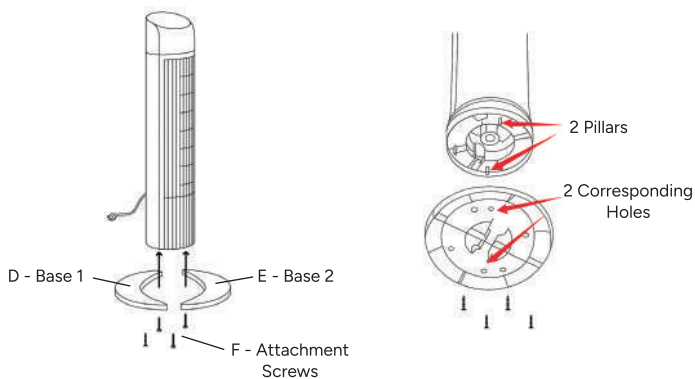



Power Button

Plug the fan into a wall socket. The display will illuminate and show the current room temperature. Press the Power button to switch the fan on. The fan will start operating at medium speed.



Speed Button

Press the Speed button to cycle through the available speed levels: low, medium and high. The selected speed will be shown on the display.



Mode Selection

Press the Mode button to choose between Normal, Nature, and Sleep modes.

Normal Mode - The fan delivers a steady, continuous airflow at the selected speed.

Nature Mode - The fan cycles through low, medium and high speeds to mimic a natural breeze.

Sleep Mode - When Sleep Mode is activated at high speed, the fan will run on high for 30 minutes, then switch to medium speed for 30 minutes, and finally operate on low speed until it is switched off automatically or manually.

If Sleep Mode is activated at medium speed, the fan will run on medium for 30 minutes before switching to low speed, where it will remain until switched off.

If Sleep Mode is activated at low speed, the fan will continue running on low speed until it is switched off.



Timer Button

Press the Timer button to set the automatic shut-off duration. The timer can be adjusted from 1 to 12 hours.



Oscillation Button

Press the Oscillation button to enable horizontal oscillation. Press the button again to turn oscillation off.

The fan can be operated using the control panel or the remote control.

Remove the protective plastic from the battery of the remote before using.
The battery type is CR2025.

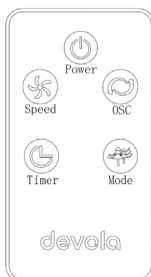

Please follow the cleaning and maintenance instruction carefully. Failure to follow these guidelines may void your warranty.

Cleaning the appliance

- Always switch off the appliance and unplug it from the socket before cleaning.
- Use a duster or soft dry cloth to clean the body of the fan and remove any dust on the fan blades and safety grill.
- Do not immerse any part of the fan in water or liquid.
- Operating the appliance in an unclean or obstructed condition may lead to damage or reduced performance and may void the warranty.

Storage

If the appliance will not be used for a prolonged period, especially in humid or coastal areas, make sure it is:

- Fully cleaned and dried.
- Stored in safe packaging to protect against dust and moisture, ideally in the original packaging.
- Kept in a dry, indoor location out of reach of children.
- The power cord can be wrapped around the base of the fan and the plug can be stored on the clip at the back of the fan.
- By following these steps, you'll help maintain the performance, appearance, and safety of your appliance for years to come.

Repairs & servicing

- The appliance contains no user-serviceable parts.
- Do not attempt to repair or modify any electrical or mechanical components.
- If the appliance is damaged, defective, or not working correctly, contact the manufacturer.

Extend your Devola warranty for free

Register your product within 30 days of purchase

When you register your Devola product on our website within 30 days of purchase, we'll extend your standard manufacturer's warranty by an additional 12 months from the point of purchase – completely free of charge.

Register on the Devola website using the QR code below



If your product develops a fault within the warranty period, we'll either:

- Repair it at no extra cost
- Replace it with a new or refurbished item of similar condition
- Cover any necessary postage costs

Please note:

- The warranty does not cover issues caused by general wear and tear, improper use, or damage not resulting from defects in materials or workmanship.
- Tampering with or opening the product will void your warranty.

If something goes wrong, get in touch with our **Customer Care Team** first. They'll guide you through the warranty process and ensure things are resolved smoothly.



Recycle unwanted materials instead of disposing of them. All appliances and packaging should be sorted and tendered at a regional recycling centre and be processed in an environmentally friendly manner.

Product registration.

Register your warranty online
within 30 days of purchase.

www.devola.co.uk/warranty

Technical details.



Support.

Address

Unit 1, Reedswood Park Road
Walsall WS2 8DQ

Helpline

0800 043 4243

Email

info@devola.co.uk

devola.co.uk